



AUGUST 2023

Newsletter

ISSUE

II

1

2

7

I

M

E

L

A

A photograph of three professionals, two women and one man, all wearing white hard hats and white long-sleeved shirts. They are standing outdoors in front of a white car, with lush green trees in the background. The man on the left is smiling and looking at a document held by the woman in the middle. The woman on the right is holding a green clipboard and looking at the same document. They appear to be in a collaborative work environment.

We encourage you to come for a site visit. We also request you to make the scheduled instalment payments for August and September as per the circulated customer statements.

Customers will get a 3% discount on their next installment if paid 30 days before due date.

11 | 1 2 7 I M E L A

MONTHLY PROJECT UPDATE

12.0 MONTHLY PROGRESS REPORT:

IRON MONGERY & DOOR FRAMES	TARGET	ACHIEVED	COMMENT
Groundfloor	May-23	100%	Completed
1st floor	June - 23	100%	Completed
2nd floor	July - 23	100%	Completed
3rd Floor	Aug-23	100%	Completed
4th Floor	Sep-23	0%	In progress

13.0 MONTHLY PROGRESS REPORT:

HOUSES + CORRIDOR PLASTER	TARGET	ACHIEVED	COMMENT
Groundfloor	Jun-23	100%	Ahead of Scheduled
1st floor	July - 23	100%	Completed
2nd floor	Aug - 23	100%	Completed
3rd Floor	Sept-23	20%	In progress
4th Floor	Oct-23	0%	Scheduled

14.0 MONTHLY PROGRESS REPORT:

HOUSES + CORRIDOR PLASTER	TARGET	ACHIEVED	COMMENT
Groundfloor	July-23	100%	Completed
1st floor	Aug - 23	100%	Completed
2nd floor	Sep - 23	100%	Completed
3rd Floor	Oct-23	0%	Scheduled
4th Floor	Nov-23	0%	Scheduled

11 | 1 2 7 I M E L A



AUGUST 2023- PROGRESS

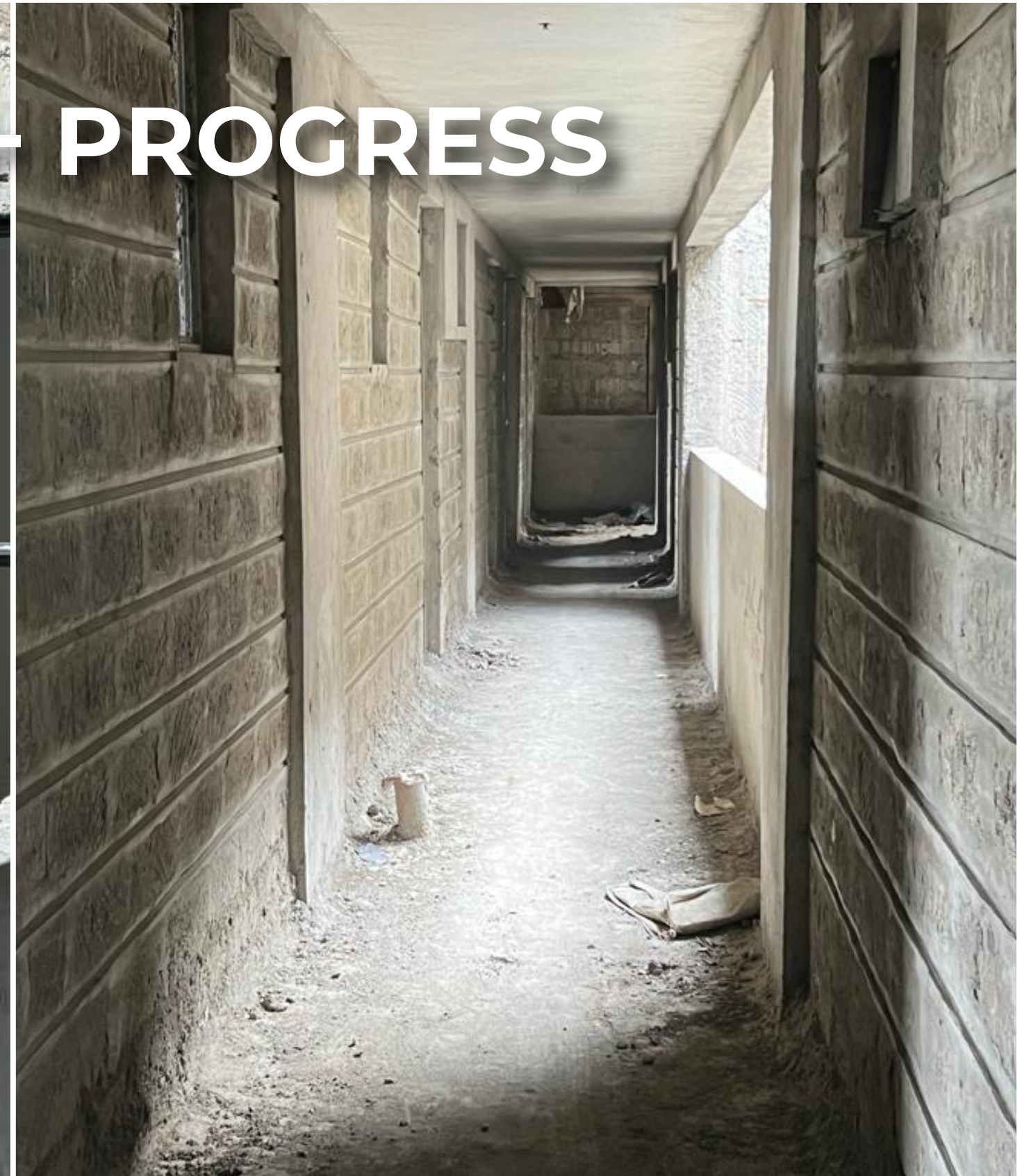

Browncap now has a customer portal that allows customers to access their **customer statements** digitally. All customer credentials have been sent, reach out if your require assistance.



Browncap Portal

1

Login to continue

Email

Password

☐ Remember me

Forgot Password?

LOGIN

BROWNCAP

allanmutuma@gmail.com

Dashboard

Client Management

Payments

Portal Admin

Dashboard

127 Imela Place

Value: KES 2,648,000

Paid: KES 1,200,000

Balance: KES 1,448,000

UNRECONCILED AMOUNTS

127 IMELA

LOCATION

OPP. KENYATTA UNIVERSITY REFERRAL HOSPITAL
EASTERN BYPASS, NAIROBI

CONTACTS

☎ 011 520 5332

✉ sales@imelaplace.co.ke

🌐 www.127imelaplace.co.ke

🐦 @127IMELA | 📘 127 IMELA PLACE | 📷 127_IMELAPLACE